

PE-Adapter for screw sockets, PE 100, SDR 11, PN 16

4524

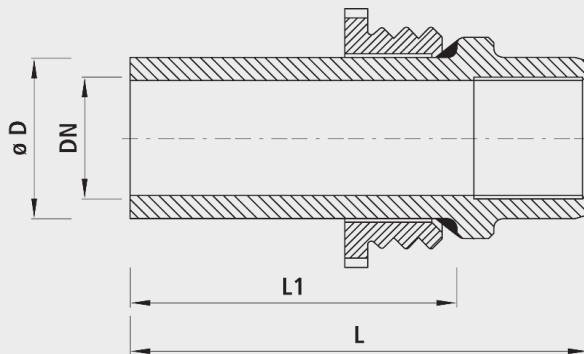

Application

- For screw sockets after DIN
- For plug-in or clamp connections, the surface must be roughened.

Characteristics

- Pressure level PN 16

Material

- PE 100, SDR 11
- Bored to SDR 17, on request
- Weld-in nozzle
- Standard: PE
- Stützhülse:
- INOX

		DN	$\varnothing D$	PN (bar)	L (mm)	L1 (mm)	weight (kg)	NPK No. 411	NPK No. 412
4524040040		40	40	16	245	200	0.390	425213	
4524040050	x	40	50	16	200	155	0.390	425213	
4524050050		50	50	16	200	155	0.390	425214	
4524050063	x	50	63	16	200	155	0.390	425215	
4524080090		80	90	16	250	200	1.400	425217	425216
4524100110		100	110	16	250	200	1.450	425218	425227
4524100125	x	100	125	16	280	230	3.700	425219	425228
4524100160	x	100	160	16	280	230	4.500	425222	
4524125125		125	125	16	250	195	1.900	425221	425238
4524125140		125	140	16	250	195	2.000	425221	425241
4524125160	x	125	160	16	310	255	5.400	425222	425242
4524150160		150	160	16	250	190	2.800	425222	425252
4524150180	x	150	180	16	320	260	6.700	425223	425253
4524150200	x	150	200	16	320	260	8.100	425224	425254
4524200200		200	200	16	250	190	4.300	425224	425254
4524200225	x	200	225	16	400	342	11.800	425225	425265
4524200250	x	200	250	16	400	342	11.800	425225	425266

x = incl. pre-fitted threaded ring