

House connection piece with thread outlet 2", PN 16

5413

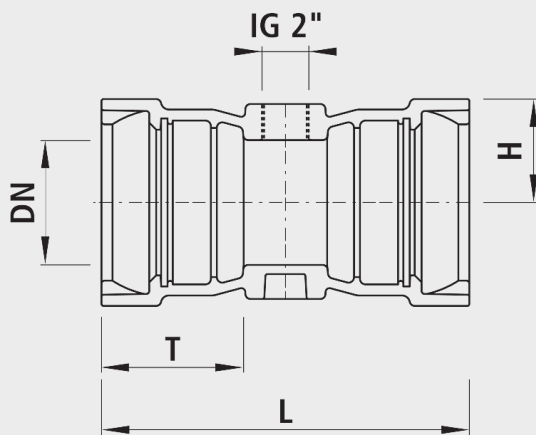

Application

- In combination with house connection slider, z.B. (No. 2520, No. 2800, No. 3130), see Chapter H.
- The BLS® socket can be used for pipes with welding beads that are secured against shearing by means of bolts. If a TYTON-SIT seal is used, for example, the fitting can also be used for all push-in socket pipes. The fittings are designed using the proven E3 gate valve technology. All BLS® valves and fittings are fitted with TYTON seals for water as standard.

Characteristics

- Operating temperature
- max. 40 °C
- Pressure level PN 16

Thrust protection



- Shearing protection bolt or clamping ring for pipe end without weld bead
- Shearing protections are not included in the scope of supply.

Material

- Housing
 - Spheroidal graphite cast iron EN-GJS-400 (GGG 40)
 - EWS coating according to GSK, RAL-GZ 662, coating thickness min. 250 µm
- Push-in sockets
 - according to DIN 28603
- Seals
 - EPDM
 - KTW and W 270 approval

Caution

- The house connection piece cannot be looped.

	DN	PN (bar)	L (mm)	H (mm)	T (mm)	weight (kg)	NPK No. 411	NPK No. 412	BIM / CAD
5413100063	100	16	360	85	135	15.900	234819	234112	
5413125063	125	16	370	97	145	21.100	234821	234113	
5413150063	150	16	400	113	150	27.500	234822	234114	
5413200063	200	16	410	140	160	39.500	234823	234115	